

A B C D E F G H I J K L M N

0 9 8 7 6 5 4 3 2 1

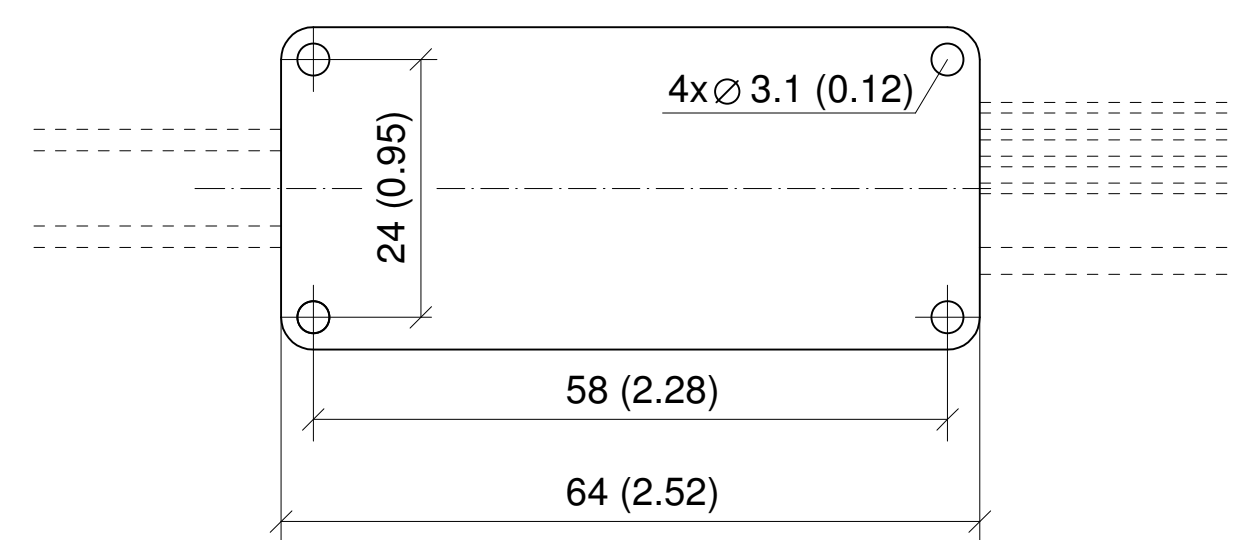
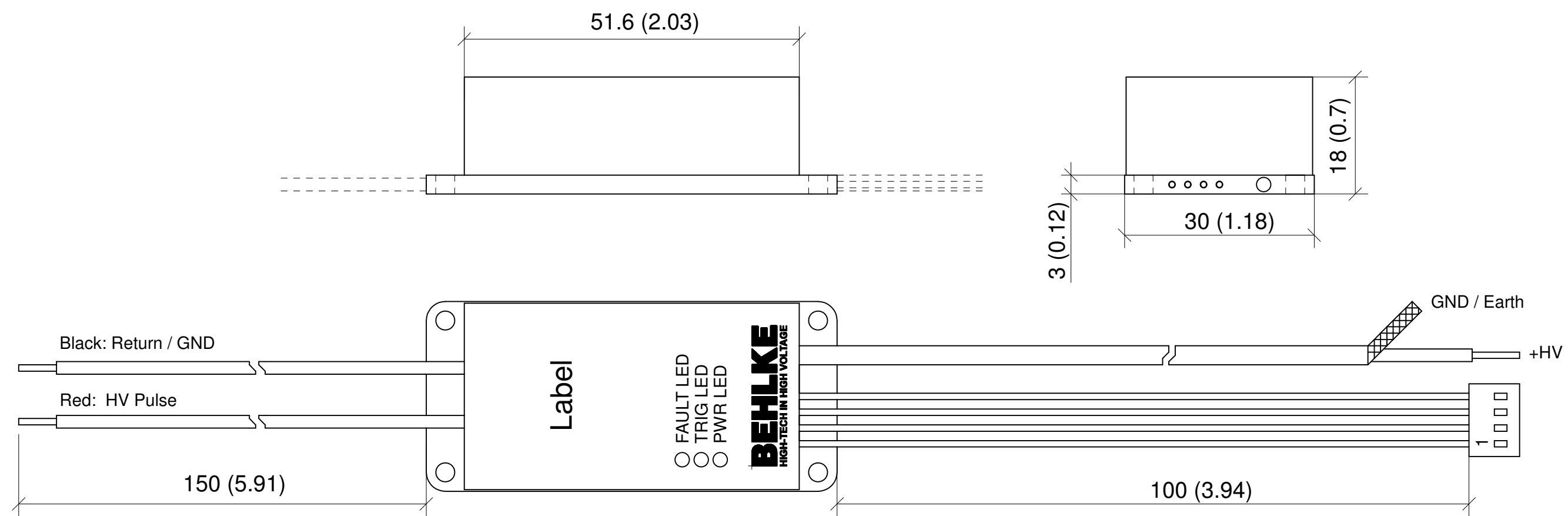

- 1- Yellow: Trigger Input (TTL, 3-6 V)
- 2- Black: GND / Ground / Return
- 3- Red: +5.0 VDC / max. 90...200 mA
- 4- Orange: Fault Signal Output (TTL)

All dimensions in mm and (inches)

Notes:
 Housing mantle is UL-94-V0 conform. Flame retardent casting resin requires additionally "Option UL".
 The housing is also available with reduced dimensions 52x30x15 mm³ (WITHOUT FLANGE, Option FC)

Änderung	Datum	Name		
			Gez.	FB
			Datum	17.09.10
			Gepr.	TM
			Datum	01.10.10
			M 1:1 (DIN A4)	

FQD 50-02-C

BEHLKE BEHLKE POWER ELECTRONICS GMBH
 Am Auernberg 4, 61476 Kronberg - Germany
 Phone +49 (0) 6173-9290-20, www.behlke.de

Z-Nr.:
 Blatt-Nr.:

A B C D E F G H I J K L M N

1 2 3 4 5 6 7 8 9 0